

**Proposed Decision to be taken by the
Portfolio Holder for Finance, Improvement and IT
on or after 19 April 2013**

**Coventry Road / Back Lane (Long Lawford)
Footway Improvements and Puffin Crossing**

Recommendation

- 1) That the Portfolio Holder for Finance, Improvement and IT approves that the following highway improvement project is included in the 2013/14 Capital Programme at a total budget of £163,000 with funding secured through a number of Section 106 contributions from Developers.

1.0 Proposal

Coventry Road / Back Lane – Footway Improvements and new Puffin Crossing to Coventry Road.

- 1.1 The above scheme is funded by a number of developers (Bloor Homes, David Wilson Homes and Cawston Consortium) through Section 106 contributions and involves the construction of a new footway on Back Lane and a new puffin crossing on the A428 Coventry Rd along with other footway improvements to Back Lane, Bilton Lane, Coventry Road and Rugby Road.
- 1.2 The new footway will provide improved pedestrian linkages for the schools and facilities for Long Lawford and link the new development, off Tee Tong Road, to the bus stop on the Coventry Road via a new Puffin Crossing. The existing footway on Back Lane will also be improved to link Long Lawford to the bus stop. A plan showing the works is included in **Appendix A**.
- 1.3 Subject to the recommendation being agreed, the County Council can undertake the works with a budget of £163,000 including fees. Under the agreement, the works will be funded by the developer's contributions. The works will be added to the Local Transport Plan programme of Minor Highway Improvement programme and procured under the Highway Maintenance Contract. Works are expected to commence at the beginning of June 2013.

2.0 Financial Considerations

- 2.1 The scheme is funded by developer Section 106 contributions. The money available from the S106 contributions is £163,000 whilst the estimated cost (including contingency) is £132,300.

| | Name | Contact Information |
|--|----------------|---|
| Report Author | Jeff Hemming | jeffhemmings@warwickshire.gov.uk Tel: 01926 412095 |
| Head of Service | Graeme Fitton | graemefitton@warwickshire.gov.uk Tel: 01926 412046 |
| Strategic Director | Monica Fogarty | monicafogarty@warwickshire.gov.uk Tel: 01926 412514 |
| Portfolio Holder (Finance, Improvement and IT) | David Wright | cllwright@warwickshire.gov.uk Tel: 07711 330040 |
| Portfolio Holder (Transport and Highways) | Peter Butlin | cllrbutlin@warwickshire.gov.uk Tel: 07989 570377 |

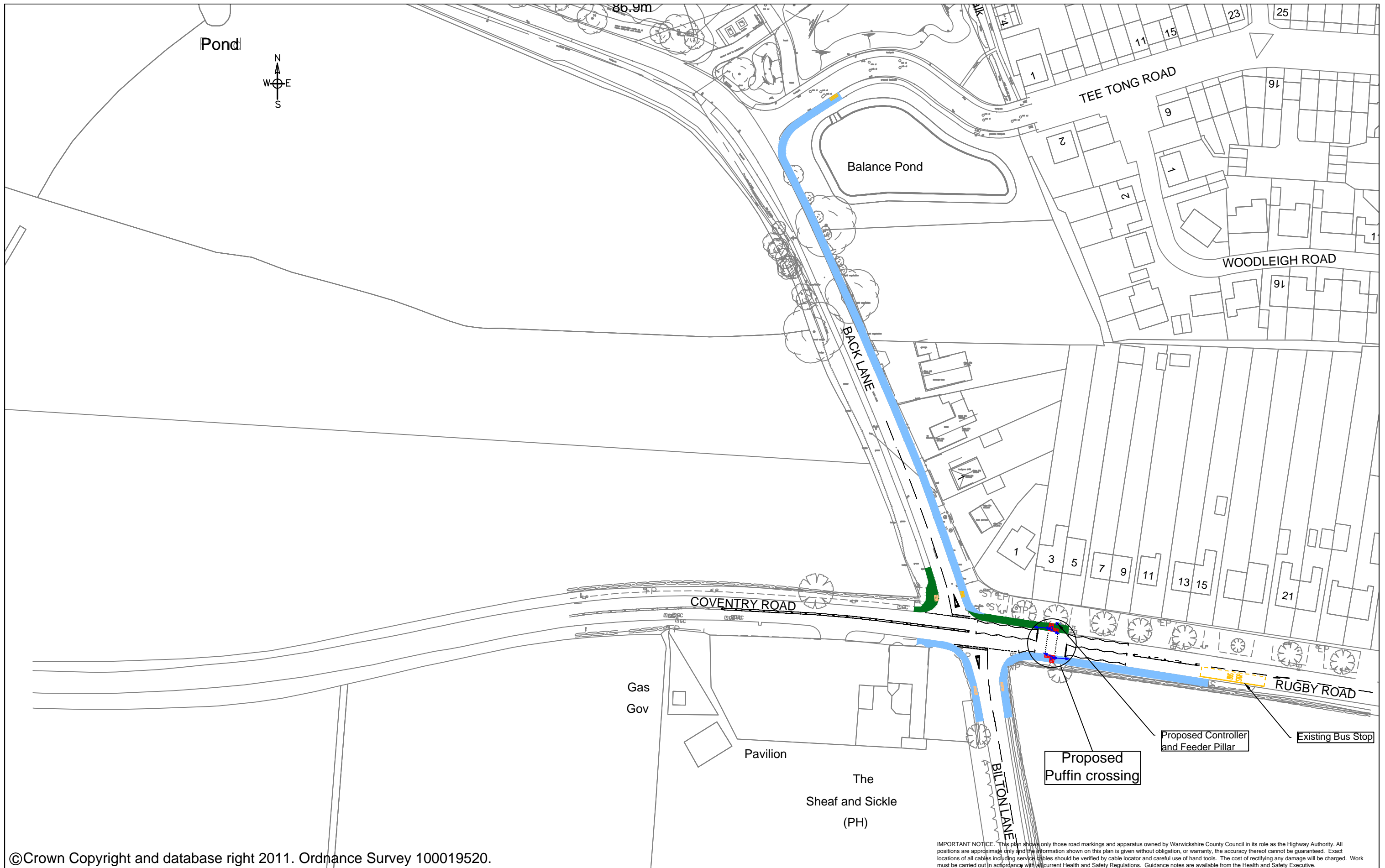

© Crown Copyright and database right 2011. Ordnance Survey 100019520.

IMPORTANT NOTICE: This plan shows only those road markings and apparatus owned by Warwickshire County Council in its role as the Highway Authority. All positions are approximate only and the information shown on this plan is given without obligation, or warranty, the accuracy thereof cannot be guaranteed. Exact locations of all cables including service cables should be verified by cable locator and careful use of hand tools. The cost of rectifying any damage will be charged. Work must be carried out in accordance with all relevant Health and Safety Regulations. Guidance notes are available from the Health and Safety Executive.



COMMUNITIES

Monica Fogarty
Strategic Director
Graeme Fitton BSc, MSc, CEng, MICE
Head of Transport for Warwickshire

NOTES
All traffic signal equipment and road markings shown are indicative and may be subject to change during detailed design or during installation due to site constraints.

- KEY
- Proposed traffic signal pole and aspects
 - Proposed tactile paving (buff / red)
 - Proposed footway (2m wide)
 - Existing footway to be widened

| Rev | Date | By | Ch'k | Amendment |
|-----|------|----|------|-----------|
| | | | | |

TITLE
**PRELIMINARY LAYOUT
PROPOSED PUFFIN CROSSING
AND NEW FOOTWAYS
CONSULTATION DRAWING
A428 RUGBY ROAD, BACK LANE,
COVENTRY ROAD & BILTON LANE
LONG LAWFORD, RUGBY**

| DRN | CK'D | AP'D |
|----------------------------|------|------|
| SJL | SJL | GHD |
| DATE March 2012 | | |
| SCALE 1:1000 at A3 | | |
| DRG. NO. SIG / 345 / 04 | | |